



Pasture to Plate

May 29-31, 2025

“You have a seat at our table”



Justina Slim

jslim@dinecollege.edu
(505) 568-2525



About this Event

The event will take place from May 29-31, 2025, at the Twin Arrows Navajo Casino Resort, located just outside Flagstaff, Arizona. The goal of this event is to offer educational workshops for both producers and consumers. Using the One Health approach we aim to teach producers the best practices for pasture and animal husbandry, empowering them to apply these strategies to their own operations. Consumers are also encouraged to attend to learn more about how their food products are sourced safely and responsibly.

The expo will feature sessions on ranch financials, mental health, and even nutritional food demonstrations. We are currently looking for knowledgeable presenters on a variety of topics. A tentative agenda outlining the structure of the expo can be found in the following pages.

jslim@dinecollege.edu
(505) 568-2525

2025

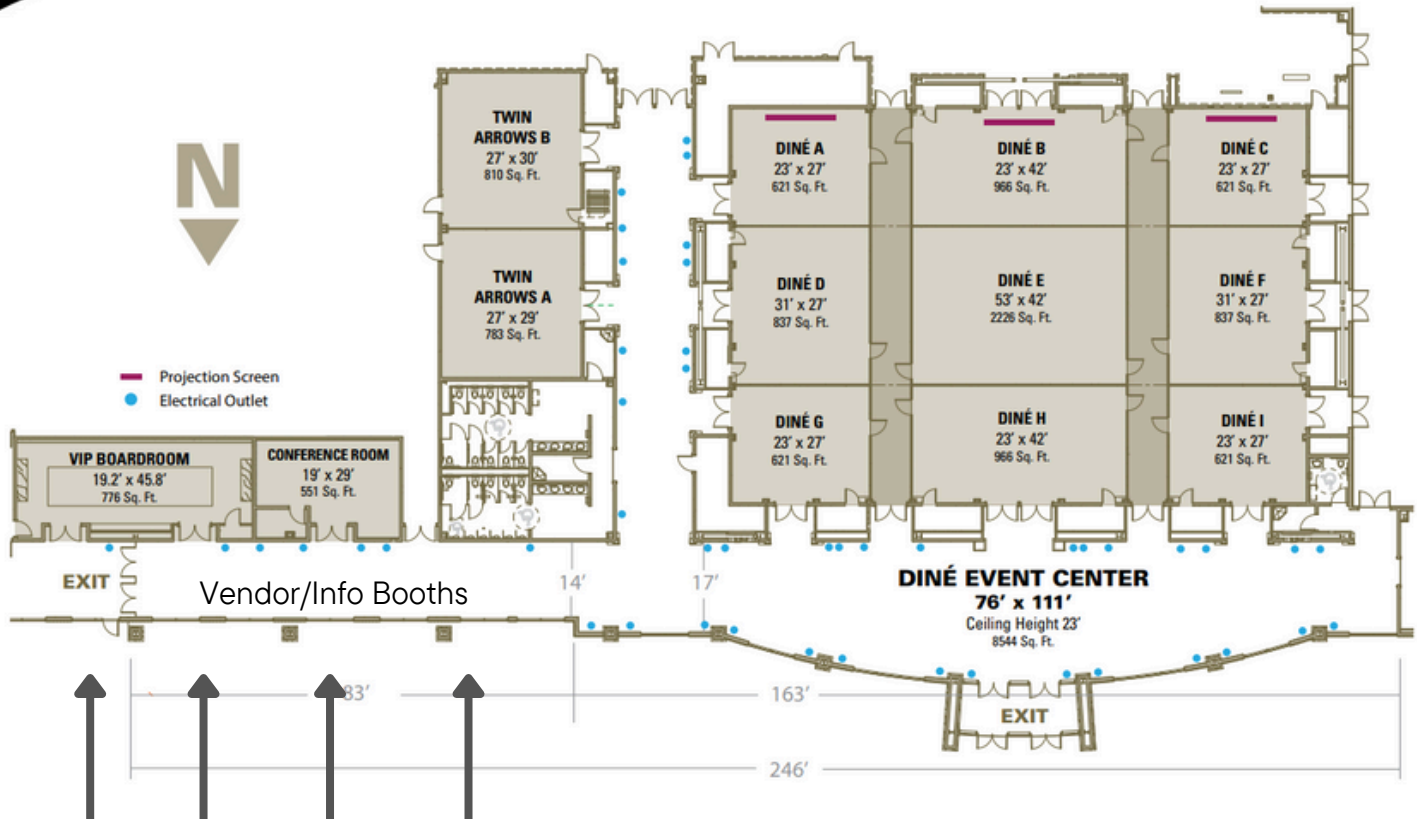

We are currently looking for vendors and informational booths to participate. These will be located in the hallway outside the VIP Board Room and Conference Room. The cost for each table is \$26.50, and payment should be made via money order to the Dine College Land Grant Office. For further details or any inquiries, please reach out to Darrell Yazzie at dyazziejr@dinecollege.edu.



May 29, 2025



8:00	Registration			
9:00	Welcome Address By Shawn Shirley and Opening Invocation by Stanley Reddye, DBMHS	Dine Event Center		
9:15	General Session Message From:	Dine Event Center		
	Room: Twin Arrows A&B	Room: Dine A,D,G	Room: Dine C,F,I	Room: Dine B,E,H
10:00	Pasture Management: Casey Spackman, NMSU Cooperative Extension Services	Erosion Control	Pasture , Rangeland, and Forage Protection Insurance: Brittany Begay, Native Land Insurance Services	Beef Quality Assurance Certification
11:00	Soil Health & Testing: Matt Denetclaw, NRCS	Virtual Fencing: Jonathan Romero, Merck Animal Health	Animal Vaccination Protocol: Dr. Manuelito	
12:00	Lunch			
1:00	Animal Vaccination Protocol: Dr. Manuelito	Pasture , Rangeland, and Forage Protection Insurance: Brittany Begay, Native Land Insurance Services	Cultural Ties to Water, Land, and Livestock: Stanley Reddye, DBMHS	
2:00	Watershed Restoration	Conservation Planning: Shirley Tolth NMSU NSAP	Pasture Management: Casey Spackman, NMSU Cooperative Extension Services	
3:00	Pasture , Rangeland, and Forage Protection Insurance: Brittany Begay, Native Land Insurance Services	Soil Health & Testing: Matt Denetclaw, NRCS	Virtual Fencing: Jonathan Romero, Merck Animal Health	
4:00	Cultural Ties to Water, Land, and Livestock: Stanley Reddye, DBMHS	Animal Vaccination Protocol: Dr. Manuelito	Pasture Management: Casey Spackman, NMSU Cooperative Extension Services	

May 30, 2025



6:00	Pasture to Plate 5k, 3k fun run and walk	Window Rock & Dilkon-NSDP		
8:00	Registration			
	Room: Twin Arrows A&B	Room: Dine A,D,G	Room: Dine C,F,I	Outside: Livestock Handling System
9:00	Cattle Nutrition		Ranch Financials: Taxes, Juan Arias, U of A Cooperative Extension	Animal Handling and Stockmanship: Curt Pate
10:00	Record Keeping: Leander Thomas, U of A Cooperative Extension	Livestock Risk Protection: Brittany Begay, Native Land Insurance Services	Agri-Stress: Gayle J. Gratop and Kristy Kinlicheenie U of A Cooperative Extension	Vaccine Demonstration: James English, Merck Animal Health
11:00	Breeding Planning	Ranch Financials: Taxes, Juan Arias, U of A Cooperative Extension	Reading EPDs 101: Marcy Ward, NMSU Extension	
12:00	Lunch			
1:00	Agri-Stress: Gayle J. Gratop and Kristy Kinlicheenie U of A Cooperative Extension	Cattle Nutrition	Reading EPDs 101: Marcy Ward, NMSU Extension	Animal Handling and Stockmanship: Curt Pate
2:00	Livestock Risk Protection: Brittany Begay, Native Land Insurance Services	Calving Preperation	Breeding Planning	Vaccine Demonstration: James English, Merck Animal Health
3:00	Ranch Financials: Taxes, Juan Arias, U of A Cooperative Extension	Record Keeping: Leander Thomas, U of A Cooperative Extension		
4:00	Reading EPDs 101: Marcy Ward, NMSU Extension —	Agri-Stress: Gayle J. Gratop and Kristy Kinlicheenie U of A Cooperative Extension	Calving Preperation	Animal Handling and Stockmanship: Curt Pate
7:00	Mix and Mingle Scholarship Fundraiser			

May 31, 2025



8:00	Navajo Women in Ag Breakfast	Alexandra Carlise, U of A Cooperative Extension		
	Room: Twin Arrows A&B	Room: Dine A,D,G	Room: Dine C,F,I	Outside: Ramada
9:00	Food Producer Safety: Lucy Li, U of A Cooperative Extension	Nutrition Education/My Plate: Garrett&Tierra, NSDP	Cattle Marketing Methods	
10:00		Beef Pallet Testing	Bashas: Becoming a vendor	Cooking demo: Shawnmarie Billison, GHWIC
11:00	Carcass Breakdown	Food Producer Safety: Lucy Li, U of A Cooperative Extension	Bird Flu-Del Yazzie NEC	
12:00	Lunch			
1:00	Nutrition label reading: NWIC/NSDP		Food Distribution Program: TeeNosPos Warehouse	Cooking demo: Genevieve Davis, Dilkon Special Diabetes Program
2:00	Beef Pallet Testing	Bashas: Becoming a vendor	Food Producer Safety: Lucy Li, U of A Cooperative Extension	
3:00	Cattle Marketing	Carcass Breakdown	Avian Flu- DALTCS	
4:00	Avian Flu: David Foley, Epidemiologist	Stress Reduction: Shawnmarie Billison, GHWIC	Beef Pallet Testing	
5:00	Closing: Innvocation and Remarks			



After reviewing the agenda, please let me know what you are able and willing to contribute to this event. Your expertise and knowledge are highly valued for this educational expo. According to the agenda, you will be presenting three different times throughout the day, ensuring that attendees who miss your session due to another can still attend. The days are organized by theme:

- Day 1: Pastures and cultural ties to the land
- Day 2: Live animals and mental health
- Day 3: Finished product education and public health

While I would like to keep presentations assigned to specific days, please inform me if any scheduling conflicts arise. I look forward to hearing from you and working together on this event.



—